

Data sheet

Support roller NATV 40 PP (crowned, with axial guidance, full needle, seal)

Designation	NATV 40 PP
Type	crowned
D [mm]	80
d [mm]	40
d1 [mm max.]	66
B1 [mm]	32
B [mm]	30
r [mm]	1,1
Dynamic load Crw[N]	41000
Static load C0rw[N]	90000
Speed limit [min-1]	1300
Speed limit [min-1]	1500

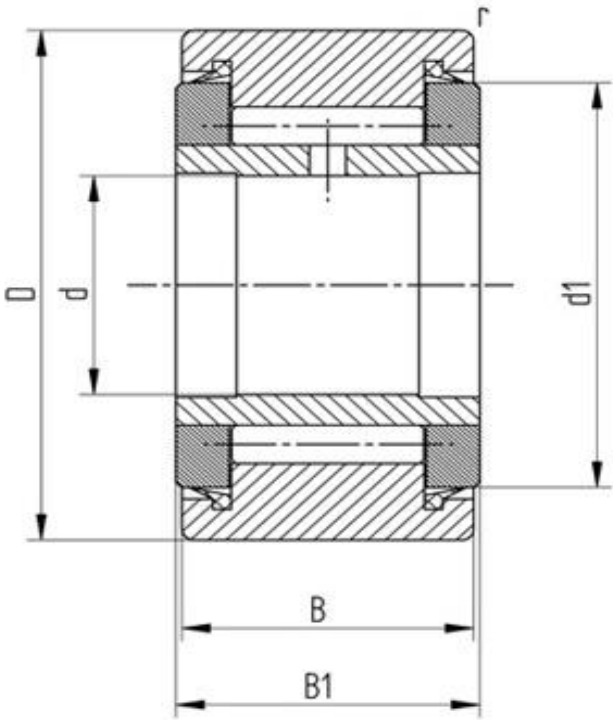

Every specification has been edited and verified carefully. STI Bearings GmbH assumes no liability for potential errors or incompleteness. Technical modifications are subject of changes.

© 2020 by STI Bearings GmbH
Reproduction, even excerpts, only with our approval.